

Trevina II 52" LED

09 Brushed Nickel 20 Antique Bronze 30 White

P2556-0930K Brushed Nickel
52" dia., 15.75" ht.
Shown with Silver blades

Silver



P2556-2030K Antique Bronze
52" dia., 15.75" ht.
Shown with Medium Cherry blades

Medium Cherry
Classic Walnut



P2556-3030K White
52" dia., 15.75" ht.
Shown with White blades

White
Natural Cherry



ENERGY INFORMATION

Airflow 4,916 cubic feet per minute
Electricity Use 62 watts (excludes lights)
DOE Weighted CFM/W 89 CFM/W

Wall Control Included
Four-speed fan operation
Full-range dimming for light
Includes switch plate cover

FEATURES

- Limited Lifetime Warranty (LED model)
- Dual Mount (flat or sloped ceiling-30°)
- Close-to-ceiling installation
- AC Motor
- Reversible plywood blades
- White opal glass shade

LAMPING

17w LED Module, 3000K, 90 CRI, 1400 source lumens, dimmable.

All fixtures:
T20 JA8

INSTALLATION

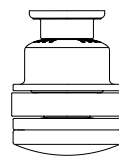

Signature Plus II

09 Brushed Nickel 20 Antique Bronze 30 White

P2539-0930K Brushed Nickel
54" dia., 15.25" ht.
Shown with Silver blades

Silver
Driftwood



P2539-2030K Antique Bronze
54" dia., 15.25" ht.
Shown with Medium Cherry blades

Medium Cherry
Classic Walnut



P2539-3030K White
54" dia., 15.25" ht.
Shown with White blades

White



ENERGY INFORMATION

Airflow 5,331 cubic feet per minute
Electricity Use 65 watts (excludes lights)
DOE Weighted CFM/W 92 CFM/W

Remote Control Included
Three-speed fan operation
Full-range dimming for light

FEATURES

- Limited Lifetime Warranty
- 45° Canopy
- Downrod mount only
- AC Motor
- Reversible MDF blades
- Opal shatterproof shade
- Remote control with batteries included
- Remote control may be replaced with P2630-30 wall control control

LAMPING

17w LED Module, 3000K, 90 CRI, 1400 source lumens, dimmable.

All fixtures:
T20 JA8